

COVID-19 Personal Protective Equipment: Doffing

Doffing Step 1: Perform Hand Hygiene

- Perform hand hygiene on the patient care gloves for a minimum of 20 seconds or until the hand sanitizer is dry



Doffing Step 2: Don Gown

- Double check gown for defect and untie any knots in the PPE
- Don the gown by inserting your arms into the sleeves with the opening to the back
- Tie the neck and waist ties in bows that are easy to release as this will facilitate easy removal by eliminating the need to struggle with untying knots



Doffing Step 3: Gloves

- Remove the gloves utilizing “glove in glove” technique
 - Take your dominant hand and pinch the palm of the non dominant hand and remove glove
 - Ball the removed glove into the hand of the remaining glove
 - Slide pointer finger of the free hand under the cuff of the remaining glove and remove
 - Place gently into the waste

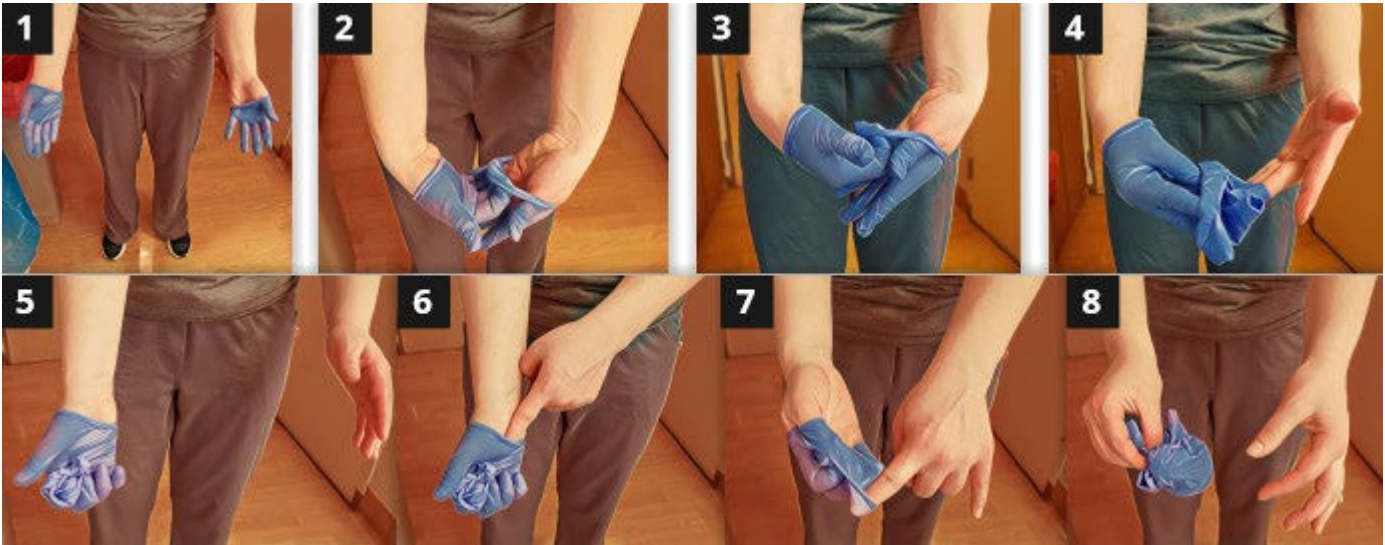

Doffing Step 4: Perform Hand Hygiene

- Perform hand hygiene on the patient care gloves for a minimum of 20 seconds or until the hand sanitizer is dry (Please validate)



Doffing Step 5: Face Shield

- The last item of PPE to come off in the patient care area, is the face shield.
- To remove it, bend slightly forward and grasp the elastic head band on both sides of your head and pull it forward and away from your face.
- Place the face shield gently into the waste face down.



Doffing Step 6: Exit the Patient Care Area

- As you exit the only item of PPE remaining is your N95 respirator.
- Exit the patient care room by opening the door, stepping out, and ensuring the door immediately and completely closes behind you.

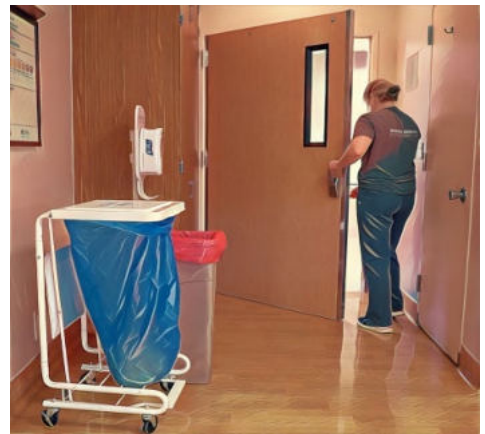

Doffing Step 7: Perform Hand Hygiene

- Perform hand hygiene on the patient care gloves for a minimum of 20 seconds or until the hand sanitizer is dry (Please verify)



Doffing Step 8: N95 Respirator

- Lean near waste container and remove N95 one strap at a time
- First remove the bottom strap of the N95 with both hands and let dangle
- Then remove top strap of N95 with both hands and place gently into the trash



Doffing Step 9: Perform Hand Hygiene

- Perform hand hygiene on the patient care gloves for a minimum of 20 seconds or until the hand sanitizer is dry (Please verify)

